

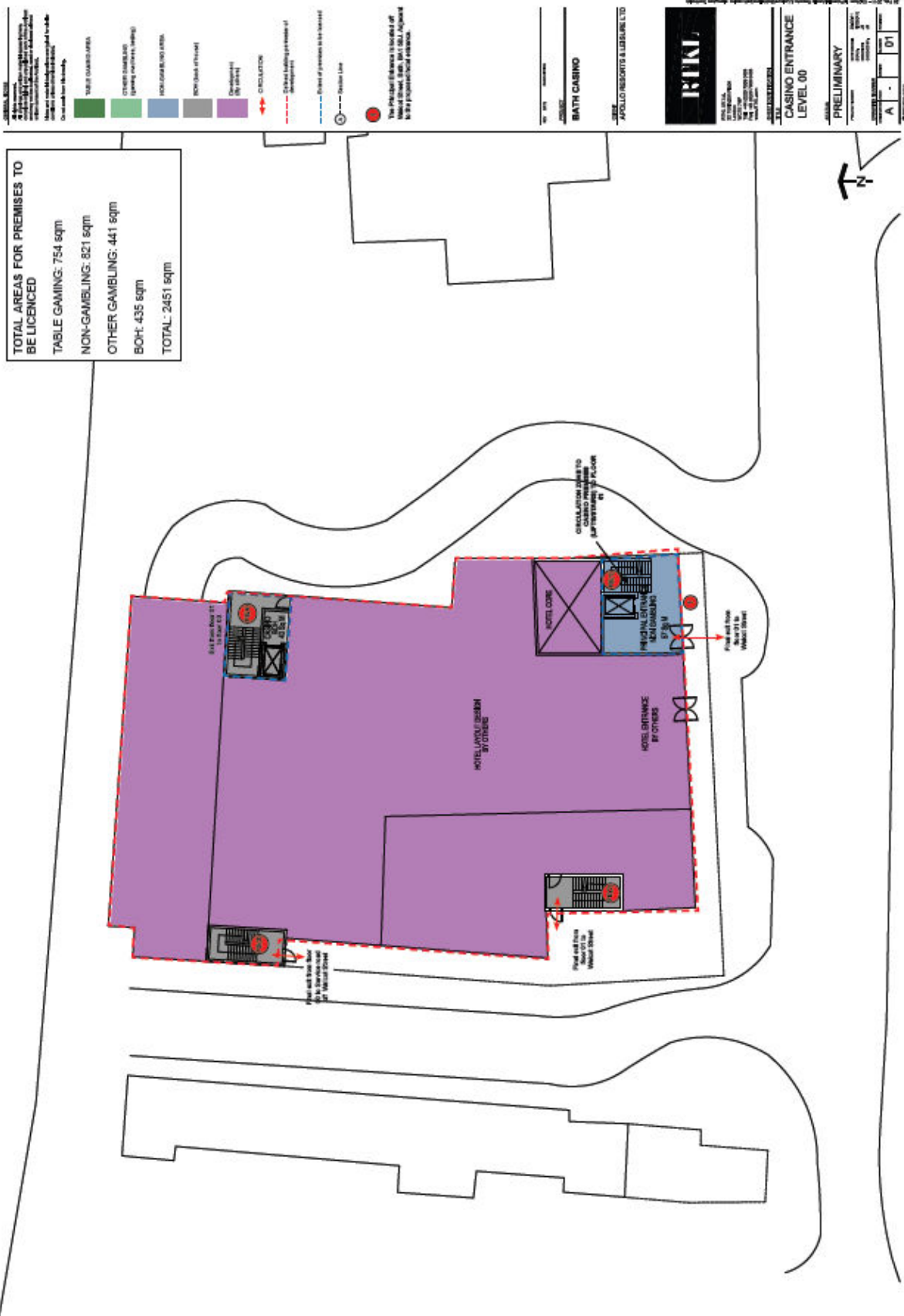

Proposed Casino Location

Proposed Site Location



TOTAL AREAS FOR PREMISES TO BE LICENCED
TABLE GAMING: 754 sqm
NON-GAMBLING: 821 sqm
OTHER GAMBLING: 441 sqm
BOH: 435 sqm
TOTAL: 2451 sqm

GENERAL NOTES
1. All areas are to be licenced for gaming purposes.
2. All areas are to be licenced for gaming purposes.
3. All areas are to be licenced for gaming purposes.
4. All areas are to be licenced for gaming purposes.
5. All areas are to be licenced for gaming purposes.

- TABLE GAMING AREA
 - OTHER GAMBLING (Light Green)
 - NON-GAMBLING AREA
 - BOH (Dark Blue)
 - Development (by other)
 - CIRCULATION
 - Exits (Red circle with white center)
 - Exit of premises (Blue circle with white center)
 - Hotel Exit (Red circle with white center)
- The proposed entrance is located off Market Street, 84th St, 501, adjacent to the proposed hotel entrance.

APOLLO RESORTS & CASINO LTD
BATH CASINO
CASINO ENTRANCE LEVEL 00
RUK
PRELIMINARY

GENERAL NOTES

1. All dimensions are to the centerline of walls unless otherwise noted.
2. All dimensions are to the centerline of walls unless otherwise noted.
3. All dimensions are to the centerline of walls unless otherwise noted.
4. All dimensions are to the centerline of walls unless otherwise noted.

Do not scale from this drawing.

	TRIPLE GLAZED AREA
	CHERRY WOOD FINISH (excluding partitions, walls)
	WOOD GRAIN FINISH (walls)
	WOOD GRAIN FINISH (walls)
	WOOD GRAIN FINISH (walls)

LEGEND

- CIRCULATION
- Other building perimeter (perimeter)
- Other perimeter to be retained
- Station Core

PROJECT INFORMATION

BATH CASINO

APOLLO RESORTS & CASINO LTD

REKJ

27, LAKEVIEW AVE
 TORONTO, ONTARIO M5S 1A5
 TEL: 416-593-8888
 FAX: 416-593-8889
 WWW.REKJ.COM

CASINO LEVEL-01

PRELIMINARY

DATE	NO.	ISSUE
2014.05.01	01	ISSUE FOR PERMIT



GENERAL NOTES:
1. All construction shall conform to the applicable provisions of the applicable editions of the International Building Code, International Code of Building Officials, and applicable local codes and ordinances.
2. All work shall be in accordance with the project specifications.

TABLE OF SYMBOLS:

TOILET REARER AREA

COMMON CIRCULATION (stairs, walkways, utility)

NON-COMMERCIAL OCCUPANCY

EXIT (door, egress)

Development (by others)

DEMOLITION
-- Dashed red line indicates an area to be demolished.

Exit
-- Blue dashed line indicates the location of an exit.

Other (development to be retained)
-- Solid blue line.

Site Boundary Line
-- Dashed red line.

Red Circle
-- The Project Engineer is hereby certifying that this Plan complies with the provisions of the applicable codes and ordinances.

PROJECT INFORMATION:
PROJECT NAME: BATH CASINO
PROJECT NUMBER: APOLLO RESORTS A101081210
DATE: 08/14/2024

